

# ZXL08

(includes former ZXL08 & ZXL08-NF models)

ACCENT & LANDSCAPE | ZX08 Series | 1.25"

3W (200lm) | 12V | HK LED, Amber



IP67

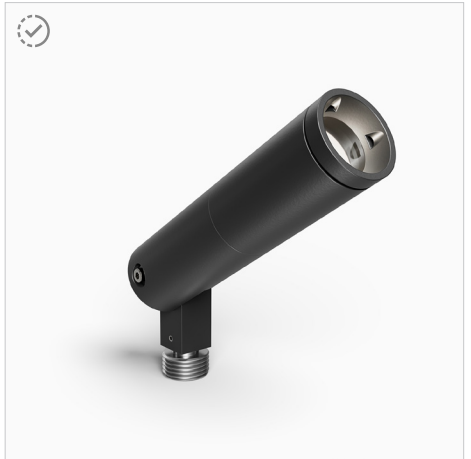

Standard Low Voltage Round Accent: ZXL08-0R1SA-ABL



Finned Low Voltage Round Accent: ZXL08-0R1FA-AAC

## FEATURES

- Our smallest round, directional 12V LED modern accent light for smaller plants, tree mounting, and architecture.
- 3W integrated HK LED delivering 200 lumens. 2200-4000K CCT, including specialty Amber option.
- Wet Location Listed, IP67 Standard.
- Machined from solid aircraft grade (6061-T6), corrosion-resistant aluminum, then anodized and powder coated to create a highly durable, marine grade finish. Also available in solid brass or stainless steel.
- 240° vertical and 360° horizontal adjustment via locking swivel stem design.
- Modular components, field changeable LED optical beams, and lenses.
- Available with adjustable Angled, Long, and Short Glare Shields and ground, surface, and canopy mounting options.
- Every fixture tested end of line for water tightness and light quality.
- Readymade eligible configurations ship in 2 to 4 weeks, complete with selected accessories installed.

## SPECIFICATIONS

### Materials

Solid billet 6061-T6 corrosion resistant aluminum with 304 stainless steel hardware. Available in 304/316 stainless steel or 360 brass upon request.

### Finish

Aluminum materials are first anodized and then powder coated for a robust, marine grade finish. Stainless steel and brass models are provided with brushed surface.

### Hood and Glare Shield

Weeping and Non-weeping Hood Styles. Set screw or threaded Angled, Short, or Long Glare Shields. (See page 4 for details).

### Voltage

12V AC/DC. Requires remote step down transformer.

### Wattage

3W HK LED, delivering 200 lumens.

### Light Engine

Innovative HK LED Light module operates like a lamp and can be easily changed in the field. CRI 90 Standard. Available in CRI 80 or CRI 95 upon request. Standard CCT options are 2700K, 3000K, 3500K, 4000K. Specialty 2200K, 2400K, 2500K, and Amber options available. Consult factory for specialty LED specification details.

### Dimming

MLV or ELV Phase Control dimming.

### Optics

Narrow (19°), Medium (26°), and Wide (51°) beam spread options available. Accepts up to 3 optical accessories (hexcel louver, optical lenses, dichroic color filters, etc.) Secured place with metal snap ring.

### Mounting

Mounts using 1/2"-14 NPS male fitting compatible with all HK Lighting Group mounting devices. (See page 4 for details).

### Listings

ETL Listed for Wet Location, IP67 Standard. RoHS Compliant.

## ORDERING GUIDE

EXAMPLE: **ZXL08-0R1SA-ABL-012V03W-27N-GSA-LVR-MHCS-06**

MODEL	PHYSICAL OPTIONS			MATERIAL / FINISH		POWER		LIGHT	
<b>ZXL08</b>	<b>OR1</b>	<b>S</b>				<b>012V</b>			
ZX08 Series 1.25" Accent Light Integrated HK LED	<b>TYPE</b>		<b>STYLE</b>	<b>HOOD</b>		<b>VOLTAGE</b>		<b>WATTAGE</b>	
	<b>OR1</b>	Low Voltage, Round Accent	<b>S</b> Standard <b>F</b> Finned	<b>A</b> A Style: Weeping <b>B</b> B Style: No Weep Holes <b>C</b> C Style: Threaded, Weeping	<b>ABL</b> Aluminum Black <b>ABR</b> Aluminum Bronze <b>AWH</b> Aluminum White <b>AAC</b> Aluminum Anodized Clear <sup>1</sup> <b>NBR</b> Natural Brass <sup>1</sup> <b>NCU</b> Natural Copper <sup>1</sup> <b>NSS</b> Natural Stainless Steel <sup>1</sup> <b>CCC</b> Custom Finish <sup>1</sup>	<b>012V</b> 12V AC	<b>03W</b> 3 Watts (200lm) <b>SPW</b> Specialty <sup>2</sup>	<b>22</b> 2200K <b>24</b> 2400K <b>25</b> 2500K <b>27</b> 2700K <b>30</b> 3000K <b>35</b> 3500K <b>40</b> 4000K <b>AM</b> Amber LED <sup>2</sup>	<b>N</b> Narrow (19°) <b>M</b> Medium (26°) <b>W</b> Wide (51°) <b>CC</b> Custom Optic

☐ Readymade eligible configurations ship in 2 to 4 weeks  
<sup>1</sup> Consult factory for specialty finish quoting and lead times  
<sup>2</sup> For Specialty AM (Amber LED). Select SPW (Specialty) for Wattage Consult factory for LED technical details before Specification or Order

## OPTIONAL INSTALLED ACCESSORIES

### GLARE SHIELD

<b>GSA</b>	A/B Glare Shield Angled
<b>GSL</b>	A/B Glare Shield Long
<b>GSS</b>	A/B Glare Shield Short
<b>CGSA</b>	C Glare Shield Angled
<b>CGSL</b>	C Glare Shield Long
<b>CGSS</b>	C Glare Shield Short

### OPTIC

<b>LVR</b>	Hexcel Louver
<b>OSL</b>	Overall Spread Lens
<b>LSL</b>	Linear Spread Lens
<b>SOL</b>	Solite Soft Focus
<b>DCF</b>	Dichroic Filter

### MOUNTING (Most common listed, see Page 4 for additional options)

<b>GROUND MOUNT</b>	
<b>MHCS-06</b>	6" PVC Single Prong Spike (12V)
<b>MHCS-12</b>	12" PVC Single Prong Spike (12V)
<b>MH02-06-BRZ</b>	6" Stainless Steel 3-Prong Spike (12V) Bronze
<b>MH02-12-BRZ</b>	12" Stainless Steel 3-Prong Spike (12V) Bronze
<b>JB-1</b>	Brass In-ground Junction Box
<b>CANOPY MOUNT</b>	
<b>CM1-XXX</b>	3.75" Square Canopy Plate
<b>CM3-XXX</b>	4.75" Square Canopy Plate
<b>CM5-XXX</b>	5" Round Canopy Plate
<b>CM5-2-XXX</b>	5" Round Canopy Plate - Double
<b>SURFACE MOUNT</b>	
<b>CMLJ-XXX</b>	2.7" Round Surface Box
<b>CB4.0-XXX</b>	4" Round Surface Box
<b>CB5.5-XXX</b>	5.5" Round Surface Box
<b>TREE MOUNT</b>	
<b>TM125-ABR</b>	Aluminum Tree Mount Box (12V)
<b>TM125-TS-ABR</b>	Stainless Steel Strap for TM125
<b>EXTENSIONS</b>	
<b>EX-12-XXX</b>	12" Extension
<b>EX-24-XXX</b>	24" Extension
<b>EL-XXX</b>	Elbow Extension

## ADDITIONAL ACCESSORIES (Not installed at time of order)

### GLARE SHIELD ACCESSORIES

<b>GSL-08-XXX</b>	A/B Glare Shield Long
<b>GSA-08-XXX</b>	A/B Glare Shield Angled
<b>GSS-08-XXX</b>	A/B Glare Shield Short
<b>CGSL-08-XXX</b>	C Glare Shield Long
<b>CGSA-08-XXX</b>	C Glare Shield Angled
<b>CGSS-08-XXX</b>	C Glare Shield Short

### OPTIC ACCESSORIES

<b>LVR-08</b>	Hexcel Louver
<b>OSL-08</b>	Overall Spread Lens
<b>LSL-08</b>	Linear Spread Lens
<b>SOL-08</b>	Solite Soft Focus
<b>DCF-08</b>	Dichroic Filter
<b>OPK-08</b>	Optic Kit - Narrow, Medium, Wide

- Consult Accessory Spec Sheet for desired option code.
- XXX represents color option.
- Readymade options available in ABL and ABR only unless noted by the part code above.

## OUTDOOR MAGNETIC TRANSFORMERS (120V input/12VAC Output)

### TRANSFORMERS (Go to [Accessories](#) for detailed specification)

EXAMPLE: **TXS-150-SS**

MODEL		WATTAGE (VA)						PRIMARY VOLTAGE (VAC)	
<b>TXM</b>	Stainless steel, wet location outdoor magnetic transformer Multitap   12VAC Output   MLV Dimming	<b>300</b>						<b>OTR-SS</b> (120V Only)	
<b>TXS</b>	Stainless steel, wet location outdoor magnetic transformer Multitap   12VAC Output   MLV Dimming	<b>150</b>	<b>300</b>	<b>600</b>				<b>SS</b> (120V Only)	
<b>TXM</b>	Compact, damp location magnetic transformer 12VAC Output   MLV Dimming	<b>20</b>	<b>40</b>	<b>60</b>	<b>100</b>	<b>150</b>	<b>300</b>	<b>120</b>	<b>277</b>
<b>IGT</b>	In ground outdoor magnetic transformer 12VAC Output   MLV Dimming	<b>50</b> (120V Only)			<b>100</b>	<b>300</b>	<b>600</b>	<b>120</b>	<b>277</b>
<b>TXE</b>	In-fixture or near mounted electronic transformer 12VAC Output   ELV Dimming   Enclosure by others	<b>60</b>						<b>120</b>	<b>277</b>

## PRODUCT DRAWINGS

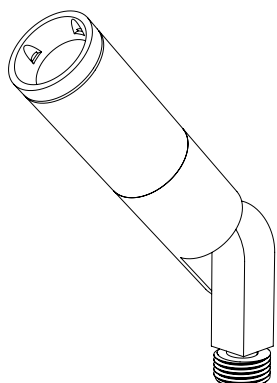

**ZXL08-OR1S**  
Standard

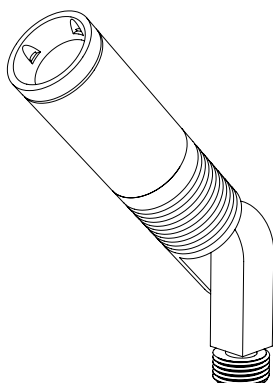

**ZXL08-OR1F**  
Finned

### ZXL08-OR1S

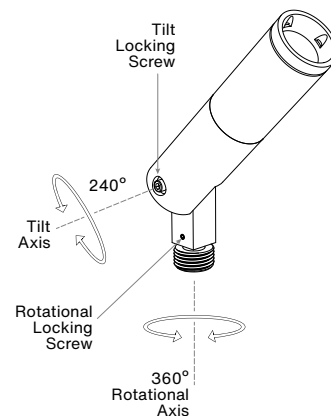
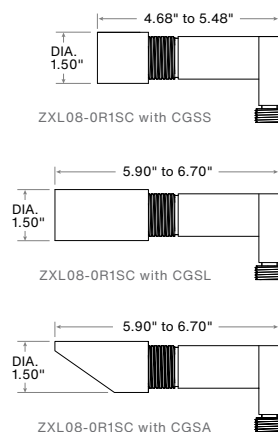
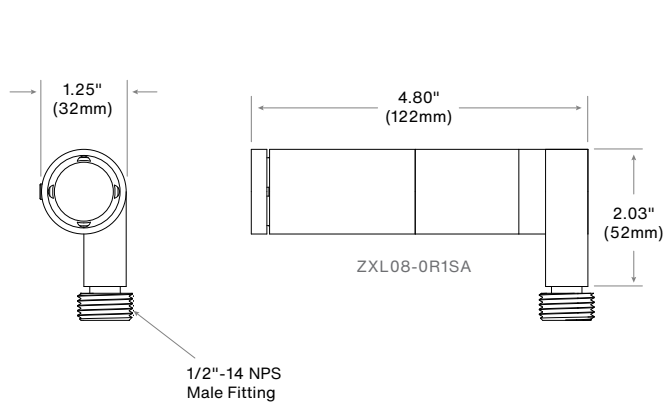

### ZXL08-OR1F

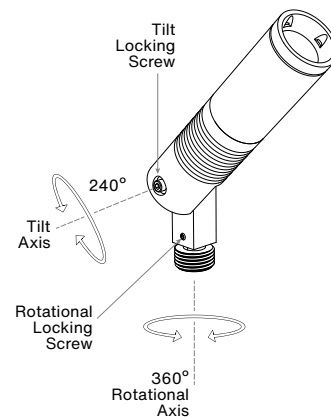
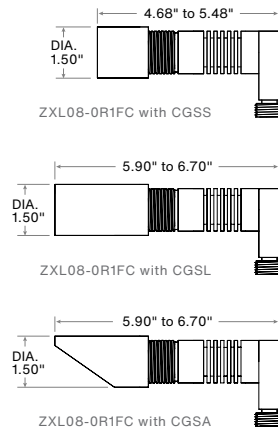
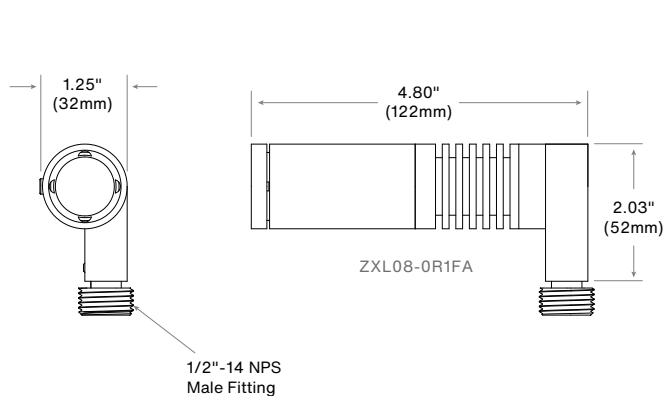

## OPTIONS & ACCESSORIES

### HOOD OPTIONS

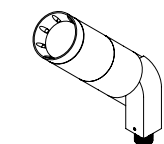

#### A HOOD

Versatile hood with 8 weep holes for water drainage. Regressed lens for glare control. Suggested for general use or when fixture is aimed in an up position.

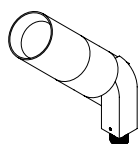

#### B HOOD

Similar to A hood but without weep holes. Regressed lens for glare control. Suggested for downlighting and interior applications.

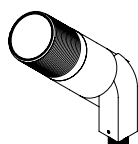

#### C HOOD

Designed for permanent use with a glare shield and innovative drainage design for water and debris. The machined threads enable ongoing glare shield adjustment, without impact to the paint surface.

### OPTIONAL GLARE SHIELD

For use with A & B Hood,  
fastened with Set Screw



**GSA**  
(angle)



**GSL**  
(long)



**GSS**  
(short)



For use with C Hood  
fastened with Locking Ring



**CGSA**  
(angle)



**CGSL**  
(long)



**CGSS**  
(short)



### MOUNTING ACCESSORIES

#### Canopy Mount:

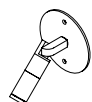

Fixture On CM5



**CM1**

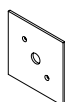

**CM3**



**CM5**



**CM5-2**

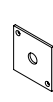

**CM2**

#### Surface Mount Box:



Fixture On CB5.1



**CMLJ**

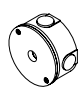

**CB4.0**

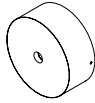

**CB5.5**

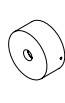

**CB3.5**

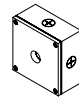

**CB4.0-SQ**

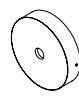

**CB5.1**

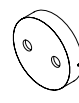

**CB5.1-2**

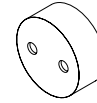

**CB5.5-2**

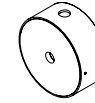

**CB5.5-2K**

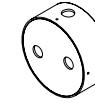

**CB5.5-2-2K**

#### Ground Mount:

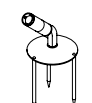

Fixture On MH02



**MHCS**



**MH02-06**



**MH02-12**



**JB-1**

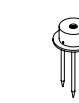

**MH02-T-06**

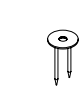

**MH05**

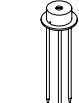

**MH02-T-12**

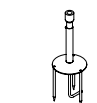

**MHVL-06-12**

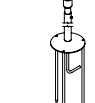

**MHVL-12-24**

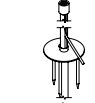

**MH01**

#### Tree Mount:

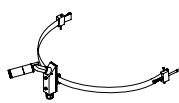

Fixture On TM120-TS



**TM125**

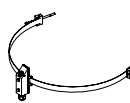

**TM125-TS**

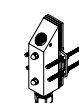

**TM125-HB**

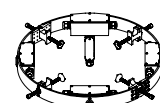

**TS-SO**

#### Extension:

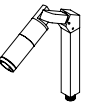

Fixture With EX,EL



**EX**



**EL**

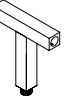

**ET**

**Sign Light Arm:** Please reference the Sign & Pole Mounting section in [Accessories](#) on our website.

Ready-made eligible configurations ship in 2 to 4 weeks.

#### Notes:

**PHOTOMETRY & ENERGY DATA**
**ZXL08 (Narrow)**

Input Power	2.97W
Color Temperature (CCT)	3000K
Color Rendering Index (Ra)	80
Beam Angle	18.4°
Max. Candlepower	1037cd
Delivered Lumens	171lm
Efficacy	57lm/W

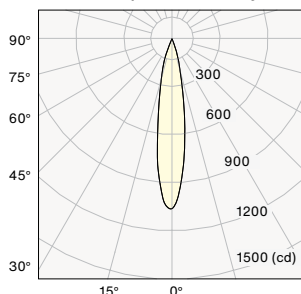
**Polar Graph - Intensity**

**Cone of Light - Illuminance**

Center Beam (fc)	Beam Diameter	Distance
259	0.6'	2.0'
65	1.3'	4.0'
29	1.9'	6.0'
16	2.6'	8.0'
10	3.2'	10.0'

1/2 Beam Angle: 18.4°

**ZXL08 (Medium)**

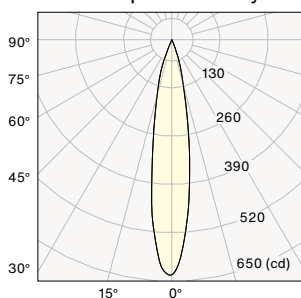
Input Power	2.98W
Color Temperature (CCT)	3000K
Color Rendering Index (Ra)	80
Beam Angle	25.4°
Max. Candlepower	636cd
Delivered Lumens	169lm
Efficacy	56lm/W

**Polar Graph - Intensity**

**Cone of Light - Illuminance**

Center Beam (fc)	Beam Diameter	Distance
159	0.9'	2.0'
40	1.8'	4.0'
17	2.7'	6.0'
10	3.6'	8.0'
6	4.5'	10.0'

1/2 Beam Angle: 25.4°

**ZXL08 (Wide)**

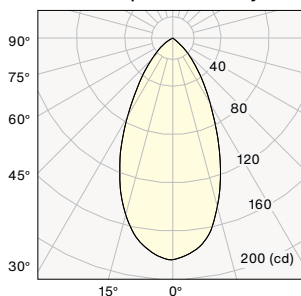
Input Power	3.0W
Color Temperature (CCT)	3000K
Color Rendering Index (Ra)	80
Beam Angle	50.9°
Max. Candlepower	183cd
Delivered Lumens	157lm
Efficacy	53lm/W

**Polar Graph - Intensity**

**Cone of Light - Illuminance**

Center Beam (fc)	Beam Diameter	Distance
46	1.9'	2.0'
11	3.8'	4.0'
5	5.7'	6.0'
3	7.6'	8.0'
2	9.5'	10.0'

1/2 Beam Angle: 50.9°

**WATTAGE MULTIPLIER**

Wattage	Multiplier
3 Watt	1.00

**CCT MULTIPLIER**

Color Temp.	Multiplier
2700k	0.96
3000k	1.00
4000k	1.03