

ZX20

(includes former ZX20 and ZX20-SOi models)

ACCENT & LANDSCAPE | ZX20 Series | 2.75"
11W (960LM) | 120, 230V | SORAA, Halogen

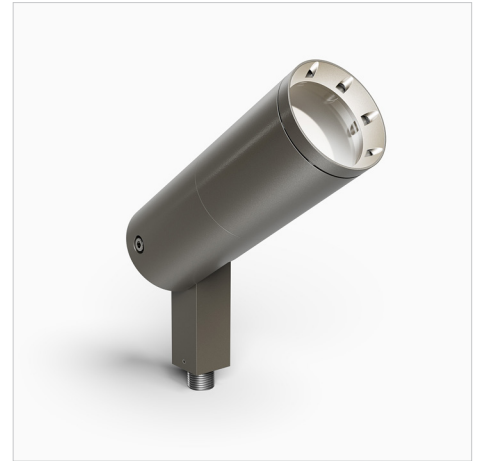

SORAA LED Standard Accent: ZX20-1R1SA-ABR

FEATURES

- Larger round, directional 120V/230V PAR20 moder accent light for residential and commercial environments.
- Flexible lamp configurations include SORAA LED Lamp with patented Heat Sink or use your preferred LED or Halogen lamp.
- Wet Location Listed, IP67 Standard.
- Machined from solid aircraft grade (6061-T6), corrosion-resistant aluminum, then anodized and powder coated to create a highly durable, marine grade finish.
- 240° vertical and 360° horizontal adjustment via locking swivel stem design.
- Field changeable optical lensing available.
- Available with adjustable Angled, Long, and Short Glare Shields and ground, surface, and canopy mounting options.
- Every fixture tested end of line for water tightness and light quality.
- Ships complete with selected accessories installed.

SPECIFICATIONS

<p>Materials Solid billet 6061-T6 corrosion resistant aluminum with 304 stainless steel hardware.</p> <p>Finish Aluminum materials are first anodized and then powder coated for a robust, marine grade finish. Stainless steel and brass models are provided with brushed surface.</p> <p>Hood and Glare Shield Weeping and Non-weeping Hood Styles. Set screw or threaded Angled, Short, or Long Glare Shields. (See page 4 for details)</p>	<p>Voltage 120V or 230V AC.</p> <p>Wattage Max. 11W for SORAA PAR20 lamp.</p> <p>Light Engine PAR20 Halogen lamp or PAR20 SORAA® LED lamp. Please refer to SORAA PAR20 for lamp selection.</p> <p>Dimming Phase dimming, with trailing edge dimming preferable. Please refer to website for SORAA PAR20 dimmer compatibility.</p>	<p>Lamp Base/Socket Standard PAR20 E26 lamp base/socket.</p> <p>Optics Accepts up to 3 accessory pieces (hexcel louver, optical lenses, dichroic color filters, etc.). Secured in place with metal snap ring.</p> <p>Mounting Mounts using 1/2"-14 NPS male fitting compatible with all HK Lighting mounting accessories (See page 4 for details).</p> <p>Listings ETL Listed for Wet Location, IP67 Standard. RoHS Compliant.</p>
---	---	--

ORDERING GUIDE

EXAMPLE: ZX20-1R1SA-ABL-120VNL-GSA-LVR-MJB-06-BRZ

MODEL	PHYSICAL OPTIONS			MATERIAL / FINISH		LIGHT ENGINE		
ZX20 ZX20 Series 2.75" Accent Light SORAA LED, LED Lamp or Halogen Lamp Low Voltage (PAR20)	1R1 TYPE 1R1 Line Voltage, Round Accent ¹	S STYLE S Standard	HOOD		ABL Aluminum Black ABR Aluminum Bronze AWH Aluminum White AAC Aluminum Anodized Clear ¹ NBR Natural Brass ¹ NCU Natural Copper ¹ NSS Natural Stainless Steel ¹ CCC Custom Finish ¹	VOLTAGE		LAMP NL No Lamp ² SL SORAA Lamp Included ³ SN SORAA Lamp Not Included ³ CC Custom Lamp Included
			A A Style: Weeping B B Style: No Weep Holes C C Style: Threaded, Weeping	120V 120V AC (PAR20) 230V 230V AC (PAR20)				

¹ Consult factory for specialty finish quoting and lead times
² Compatible with Halogen Lamp
³ Only compatible with SORAA LED Lamp

OPTIONAL INSTALLED ACCESSORIES

SORAA LAMP	GLARE SHIELD	OPTIC	MOUNTING (Most common listed, see Page 4 for additional options)
XXXXX SORAA LED Lamp Code	GSA A/B Glare Shield Angled GSL A/B Glare Shield Long GSS A/B Glare Shield Short CGSA C Glare Shield Angled CGSL C Glare Shield Long CGSS C Glare Shield Short	LVR Hexcel Louver OSL Overall Spread Lens LSL Linear Spread Lens SOL Solite Soft Focus DCF Dichroic Filter	GROUND MOUNT MHJB-06-BRZ 6" Stainless Steel 3-Prong Spike (120-277V) Bronze MHJB-12-BRZ 12" Stainless Steel 3-Prong Spike (120-277V) Bronze JB-1 Brass In-ground Junction Box CANOPY MOUNT CM1-XXX 3.75" Square Canopy Plate CM3-XXX 4.75" Square Canopy Plate CM5-XXX 5" Round Canopy Plate CM5-2-XXX 5" Round Canopy Plate - Double SURFACE MOUNT CMLJ-XXX 2.7" Round Surface Box CB4.0-XXX 4" Round Surface Box CB5.5-XXX 5.5" Round Surface Box TREE MOUNT TM07-JBS-XXX Single Aluminum Tree Mount Box with Stainless Steel Strap (120V) TM07-JBT-XXX Twin Aluminum Tree Mount Box with Stainless Steel Strap (120V) EXTENSIONS EX-12-XXX 12" Extension EX-24-XXX 24" Extension EL-XXX Elbow Extension

- Consult Accessory Spec Sheet for desired option code.
- XXX represents color option.

ADDITIONAL ACCESSORIES (Not installed at time of order)

GLARE SHIELD ACCESSORIES	OPTIC ACCESSORIES
GSL-20-XXX A/B Glare Shield Long GSA-20-XXX A/B Glare Shield Angled GSS-20-XXX A/B Glare Shield Short CGSL-20-XXX C Glare Shield Long CGSA-20-XXX C Glare Shield Angled CGSS-20-XXX C Glare Shield Short	LVR-20 Hexcel Louver OSL-20 Overall Spread Lens LSL-20 Linear Spread Lens SOL-20 Solite Soft Focus DCF-20 Dichroic Filter

PRODUCT DRAWINGS

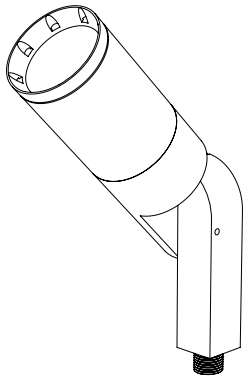

ZX20-1R1S

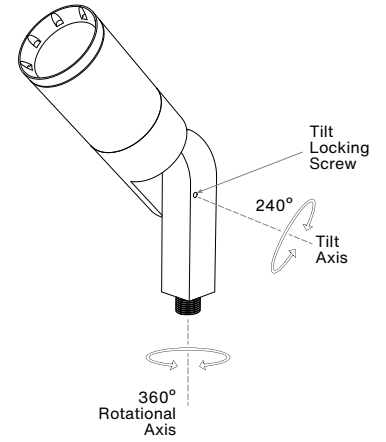
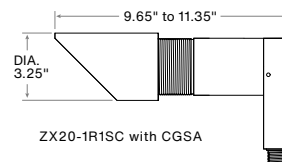
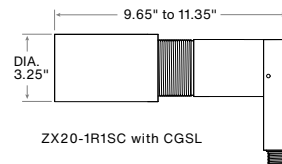
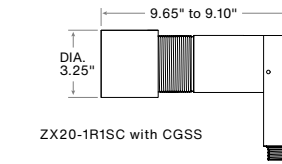
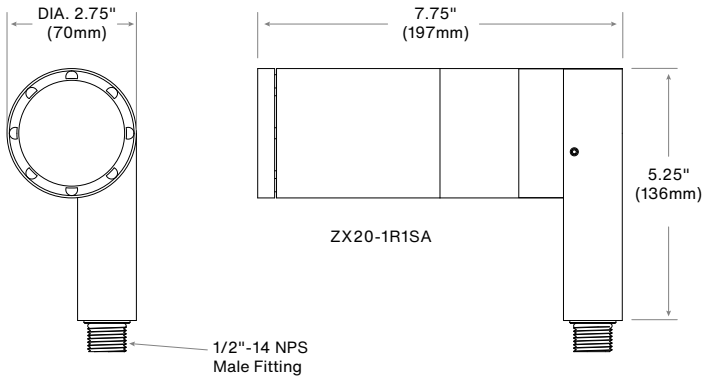

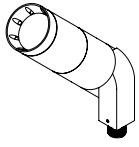
OPTIONS & ACCESSORIES
HOOD OPTIONS

A-HOOD
Versatile hood with 8 weep holes for water drainage. Regressed lens for glare control. Suggested for general use or when fixture is aimed in an up position.

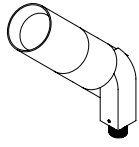

B-HOOD
Similar to A hood but without weep holes. Regressed lens for glare control. Used in an interior or down light application.

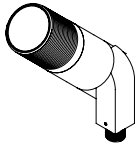

C-HOOD
Flush hood with machined threading on the outside for attachment of C-style glare shield, cleverly designed with hidden drainage channels.

OPTIONAL GLARE SHIELD

 For use with A & B Hood,
fastened with Set Screw

 GSA
(angle)

 GSL
(long)

 GSS
(short)

 For use with C Hood
fastened with Locking Ring

 CGSA
(angle)

 CGSL
(long)

 CGSS
(short)

MOUNTING ACCESSORIES
Canopy Mount:



Fixture On CM5



CM2

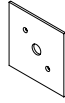

CM1



CM3



CM5



CM5-2

Surface Mount Box:

Fixture On CB5.1



CMLJ



CB4.0



CB4.0-SQ



CB5.1



CB5.5

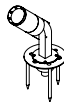

CB5.5-K/O

Ground Mount:

Fixture On MHJB-06



MHJB-06

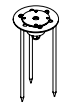

MHJB-12

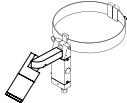

JB-1

Tree Mount:

Fixture On TM07-JBS

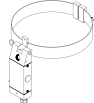

TM07-JBS

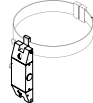

TM07-JBT

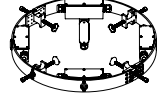

TS-SO

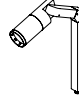
Extension:

Fixture With EX,EL



EX

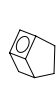

EL

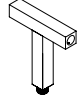

ET

Sign Light Arm: Please reference the Sign & Pole Mounting section in [Accessories](#) on our website.

Notes: