

ZXG-RH-LED/ZXGi-RH-LED

LED In-grade . ZXG Series



Product Features

- Stainless steel in-grade fixture with superior corrosion resistance.
- ETL outdoor wet location listed. IP67 standard.
- Compact size with 4" diameter profile.
- Built-in optic accessory holder.
- Modular components - field changeable LED module & beam spread reflectors.
- Line voltage input with integral step down transformer in fixture housing.

Specification

Materials:

Outer housing: Stainless steel.
Lamp holder and Aiming Assembly: Machined from billet 6061-T6 corrosion resistant aluminum.

Voltage:

12V AC/DC. Requires remote step down transformer. Line voltage models come with integral transformer.

Wattage: 5W HK LED.

Dimmability:

12V -- MLV or ELV depending on the transformer used. Line voltage -- MLV dimming(consult factory for other types of dimming).

Light Source: CRI 83. Available in CRI95 upon request. The chromaticity range is within a 3-step McAdam Ellipse. Standard CCT options are 2700K, 3000K, 4000K.

Lamp Base/Socket: Innovative cone-shaped lamp base and receptacle socket maximize the surface contact area to dissipate heat more effectively. See "Resources" for details.

Finish: Natural Stainless Steel.

Optical Accessories: Standard is with hexcel louver. Accepts up to 3 additional accessory pieces (hexcel louver, optical lenses, dichroic color filters, etc.). Secured in place with metal snap ring.

Ordering Guide

EXAMPLE: ZXG-RH-LED - 12V - 5 - 27 - 20 - NSS - LVR - FLANGE

SERIES	VOLTAGE	WATTAGE	CCT	OPTICS	FINISH	OPTIONAL, SELECT UP TO 2 OPTIC ACCESSORIES	OPTIONAL ACCESSORIES
ZXG-RH-LED	12 12V	5 5W	27 2700K 30 3000K 40 4000K	20 20° 33 33° 44 44° 57 57°	NSS Natural Stainless Steel	LVR Hexcel Louver OSL Overall Spread Lens LSL Linear Spread Lens SOL Solite Soft Focus DF Dichroic Filter	See page 3 for quick reference, or "Accessories" link for detailed specification.
ZXGi-RH-LED	120 120V						

Remote Step Down Transformer for 12V fixture(Optional). See "Accessories" link for detailed specification.

Model	Wattage(VA)	Primary Voltage(VAC)	Secondary Volt(VAC)	Dimming Method	Characters
TXM	20 40 60 100 150 300	120 or 277	12	MLV	Outdoor, Wall Mount, Compact
TXS	150 300 600	120	Multi-tap of 12, 13, 14, 15 VAC	MLV	Outdoor, Wall mount, Stainless Steel Case
IGT	50(120V only) 100 300 600	120 or 277	12	MLV	In-grade
TXE	60	120, 230, or 277	12	ELV	Needs Enclosure, 6ft working distance

Product Drawings

NOTE: Specification and dimensions subject to change without notice.

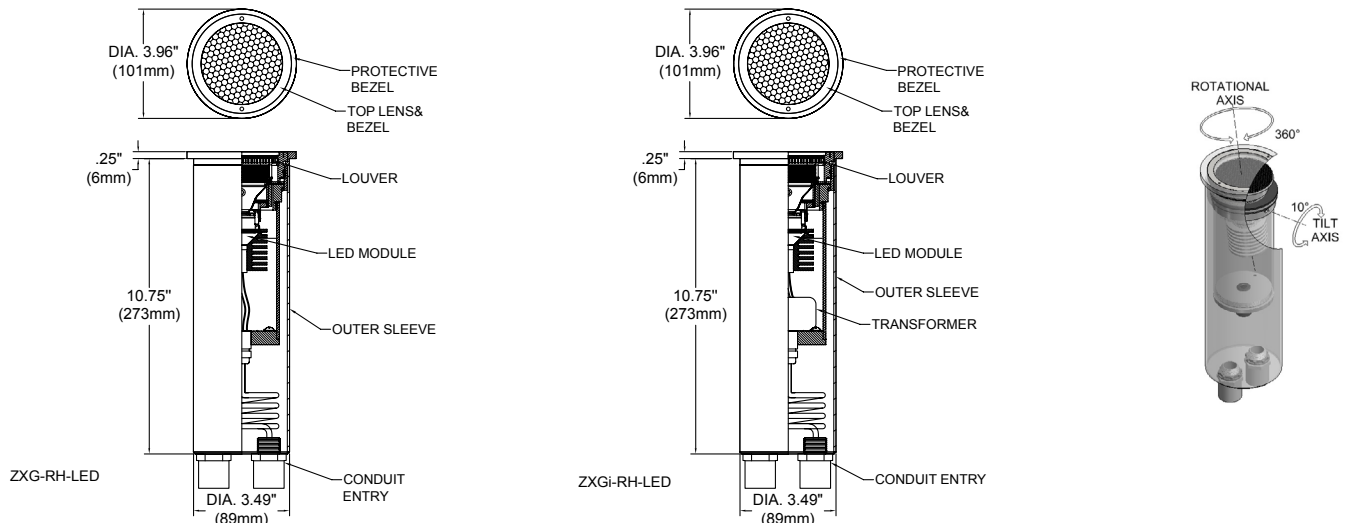

Photometry & Energy Data

MODEL ZXG-RH-LED-5W-N

Input Power	4.7W
Color Temperature (CCT)	3000K
Color Rendering Index (Ra)	83
Beam Angle	20.5°
Max. Candlpower	1999cd
Delivered Lumens	492lm
Efficacy	105lm/W

Polar Graph - Intensity

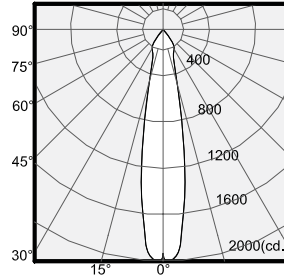

Cone of Light - Illuminance

Center Beam (fc)	Beam Diameter	Distance
500	0.7'	2.0'
125	1.4'	4.0'
56	2.2'	6.0'
31	2.9'	8.0'
20	3.6'	10.0'

1/2 Beam Angle: 20.5°

MODEL ZXG-RH-LED-5W-M

Input Power	4.7W
Color Temperature (CCT)	3000K
Color Rendering Index (Ra)	83
Beam Angle	32.5°
Max. Candlpower	1050cd
Delivered Lumen	492lm
Efficacy	105lm/W

Polar Graph - Intensity

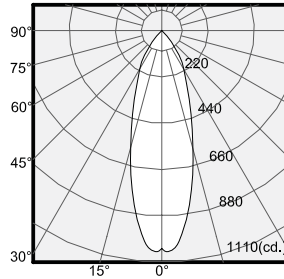

Cone of Light - Illuminance

Center Beam (fc)	Beam Diameter	Distance
263	1.2'	2.0'
66	2.3'	4.0'
29	3.5'	6.0'
16	4.6'	8.0'
11	5.8'	10.0'

1/2 Beam Angle: 32.5°

MODEL ZXG-RH-LED-5W-W

Input Power	4.7W
Color Temperature (CCT)	3000K
Color Rendering Index (Ra)	83
Beam Angle	44.1°
Max. Candlpower	759cd
Delivered Lumen	495lm
Efficacy	103lm/W

Polar Graph - Intensity

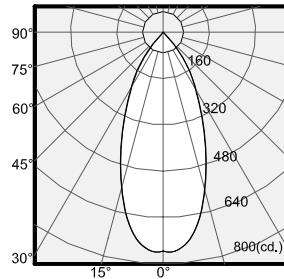

Cone of Light - Illuminance

Center Beam (fc)	Beam Diameter	Distance
190	1.6'	2.0'
47	3.2'	4.0'
21	4.9'	6.0'
12	6.5'	8.0'
8	8.1'	10.0'

1/2 Beam Angle: 44.1°

MODEL ZXG-RH-LED-5W-VW

Input Power	4.7W
Color Temperature (CCT)	3000K
Color Rendering Index (Ra)	83
Beam Angle	56.9°
Max. Candlpower	581cd
Delivered Lumen	499lm
Efficacy	106lm/W

Polar Graph - Intensity

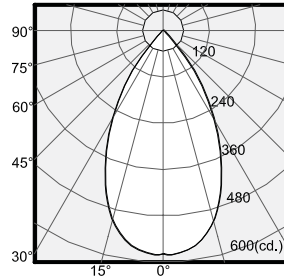

Cone of Light - Illuminance

Center Beam (fc)	Beam Diameter	Distance
145	2.3'	2.0'
36	4.6'	4.0'
16	6.9'	6.0'
9	9.2'	8.0'
6	11.5'	10.0'

1/2 Beam Angle: 56.9°

CCT Multiplier Table

Color Temp.	Multiplier
2700K	0.97
3000K	1.00
4000K	1.05

Accessories

Bottom Flange:

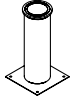

Fixture With Flange



Flange

Notes