

ZP16

(includes former PATH-1-SOi & PATH-2-SOi models)

PATH & BOLLARD | ZP16 Series | 2.25"

7.5W (640LM) | 12V | SORAA, LED Lamp, Halogen



FEATURES

- Versatile directional 12V MR16 (GU5.3) path light for residential and commercial environments.
- Flexible lamp configurations include SORAA LED Lamp with patented Heat Sink or use your preferred LED or Halogen lamp.
- Wet Location Listed, IP67 Standard.
- Machined from solid aircraft grade (6061-T6), corrosion-resistant aluminum, then anodized and powder coated to create a highly durable, marine grade finish. Also available in solid brass or stainless steel.
- 240° vertical and 360° horizontal light adjustment via locking swivel stem design.
- Modular components, field changeable LED optical beams, and lenses.
- Available with adjustable Angled, Long, and Short Glare Shields and ground, surface.
- Single and double light mounting options at 12", 24", 30" or custom height.
- Every fixture tested end of line for water tightness and light quality.
- Readymade eligible configurations ship in 2 to 4 weeks, complete with selected accessories installed.

SECIFICATIONS

Materials

Solid billet 6061-T6 corrosion resistant aluminum with 304 stainless steel hardware.

Finish

Aluminum materials are first anodized and then powder coated for a robust, marine grade finish. Stainless steel and brass models are provided with brushed surface.

Hood and Glare Shield

Weeping and Non-weeping Hood Styles. Set screw or threaded Angled, Short, or Long Glare Shields. (See page 4 for details).

Voltage

12V AC/DC. Requires remote step down transformer.

Wattage

Max 9W for SORAA MR16 lamp with Thermobuster. Max 50W for halogen lamp.

Light Engine

MR16 Halogen lamp or MR16 SORAA® LED lamp. Please refer to [SORAA MR16 GU5.3](#) lamp selection.

Dimming

MLV, ELV Phase Control dimming. Please refer to website for [SORAA® MR16](#) dimmer compatibility.

Lamp Base/Socket

Standard bi-pin socket for GU5.3/G4/GX5.3/GY6.35/GZ4.

Optics

Accepts up to 3 accessories (hexcel louver, optical lenses, dichroic color filters, etc.). Secured in place with metal snap ring.

Mounting

Mounts using 1/2"-14 NPS male fitting compatible with all HK Lighting Group mounting devices. (See page 4 for details).

Listings

ETL Listed for Wet Location, IP67 Standard. RoHS Compliant.



Low Voltage Path Light: ZP16-0R1SA-ABR

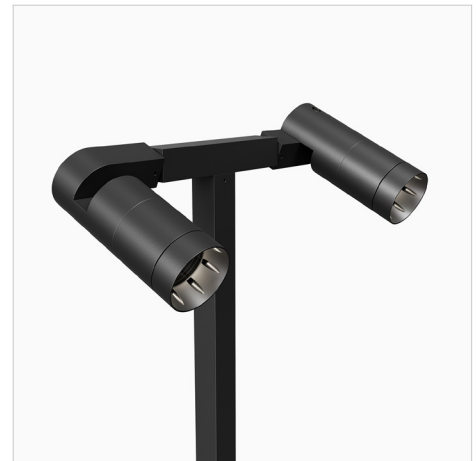

Twin Head Low Voltage Path Light: ZP16-0R2SA-AAC

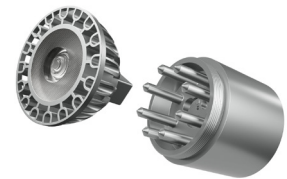

Integral SORAA® Heat Sink

US patented Thermobuster™ provides extra heat dissipation that reduces the lamp junction temperature by 77°F(25°C). Enables even the highest wattage SORAA® lamps to be used in an enclosed fixture without sacrificing its performance or life expectancy.

ORDERING GUIDE

EXAMPLE: ZP16-0R1SA-ABL-012VSL-08728-12-GSA-LVR-MH02-12-BRZ

MODEL	PHYSICAL OPTIONS			MATERIAL / FINISH			POWER		SORAA LAMP		EXTENSION		
ZP16							012V						
ZP16 Series 2.25" Path Light Integrated HK LED, SORAA LED Low Voltage (GU-5.3)	TYPE		S	HOOD		ABL Aluminum Black	VOLTAGE		LAMP		XXXXX SORAA LED Lamp Code	LENGTH	
	OR1	Low Voltage, Round Single Light	S Standard	A	A Style: Weeping	ABR Aluminum Bronze	012V 12V AC (GU5.3 Lamp)	NL No Lamp ²	SL SORAA Lamp Included ³	08728 SORAA Brilliant HL 7.5W	12	12"	
	OR2	Low Voltage, Round Double Light		B	B Style: No Weep Holes	AWH Aluminum White					24	24"	
				C	C Style: Threaded, Weeping	AAC Aluminum Anodized Clear ¹		SN SORAA Lamp Not Included ³			30	30"	
						NBR Natural Brass ¹		CC Custom Lamp Included			CC	Custom	
						NCU Natural Copper ¹							
						NSS Natural Stainless Steel ¹							
						CCC Custom Finish ¹							

- Readymade eligible configurations ship in 2 to 4 weeks
- ¹ Consult factory for specialty finish quoting and lead times
- ² Compatible with Halogen Lamp
- ³ Only compatible with SORRA LED Lamp

OPTIONAL INSTALLED ACCESSORIES

GLARE SHIELD	OPTIC	MOUNTING (Most common listed, see Page 4 for additional options)
GSA A/B Glare Shield Angled	LVR Hexcel Louver	GROUND MOUNT
GSL A/B Glare Shield Long	OSL Overall Spread Lens	MH02-06-BRZ 6" Stainless Steel 3-Prong Spike (12V) Bronze
GSS A/B Glare Shield Short	LSL Linear Spread Lens	MH02-12-BRZ 12" Stainless Steel 3-Prong Spike (12V) Bronze
CGSA C Glare Shield Angled	SOL Solite Soft Focus	JB-1 Brass In-ground Junction Box
CGSL C Glare Shield Long	DCF Dichroic Filter	CANOPY MOUNT
CGSS C Glare Shield Short		CM1-XXX 3.75" Square Canopy Plate
		CM3-XXX 4.75" Square Canopy Plate
		CM5-XXX 5" Round Canopy Plate
		CM5-2-XXX 5" Round Canopy Plate - Double
		SURFACE MOUNT
		CMLJ-XXX 2.7" Round Surface Box
		CB4.0-XXX 4" Round Surface Box
		CB5.5-XXX 5.5" Round Surface Box

ADDITIONAL ACCESSORIES (Not installed at time of order)

- Consult Accessory Spec Sheet for desired option code.
- XXX represents color option.
- Readymade options available in ABL and ABR only unless noted by the part code above.

GLARE SHIELD ACCESSORIES	OPTIC ACCESSORIES
GSL-16-XXX A/B Glare Shield Long	LVR-16 Hexcel Louver
GSA-16-XXX A/B Glare Shield Angled	OSL-16 Overall Spread Lens
GSS-16-XXX A/B Glare Shield Short	LSL-16 Linear Spread Lens
CGSL-16-XXX C Glare Shield Long	SOL-16 Solite Soft Focus
CGSA-16-XXX C Glare Shield Angled	DCF-16 Dichroic Filter
CGSS-16-XXX C Glare Shield Short	OPK-16 Optic Kit-Narrow, Medium, Wide

OUTDOOR MAGNETIC TRANSFORMERS (120V input/12VAC Output)

TRANSFORMERS (Go to [Accessories](#) for detailed specification)

EXAMPLE: TXM-20-120

MODEL		WATTAGE (VA)	PRIMARY VOLTAGE (VAC)
TXM	Compact, damp location magnetic transformer 12VAC Output MLV Dimming	20, 40, 60, 100, 150, 300	120, 277
TXM	Stainless steel, wet location outdoor magnetic transformer with integrated light sensor Multitap 12VAC Output MLV Dimming	300	OTR-SS (120V Only)
TXS	Stainless steel, wet location outdoor magnetic transformer Multitap 12VAC Output MLV Dimming	150, 300, 600	SS (120V Only)
IGT	In-grade outdoor magnetic transformer 12VAC Output MLV Dimming	50 (120V Only), 100, 300, 600	120, 277
TXE	In-fixture or near mounted electronic transformer 12VAC Output ELV Dimming Enclosure by others	60	120, 230, 277

PRODUCT DRAWINGS

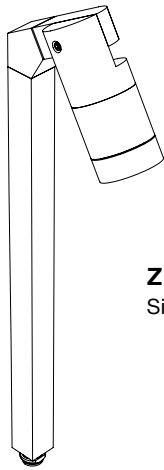

ZP16-OR1SA
Single - 12" Extension

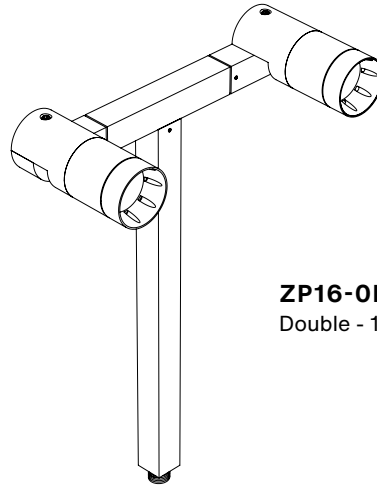

ZP16-OR2SA
Double - 12" Extension

ZP16-OR1SA

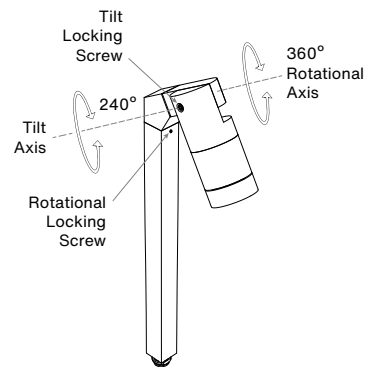
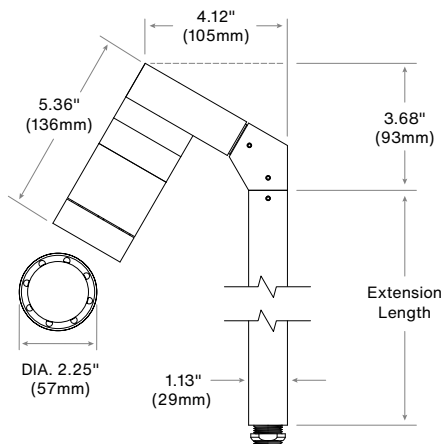

ZP16-OR2SA

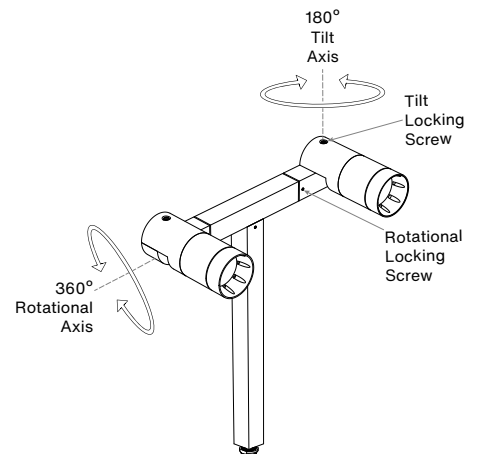
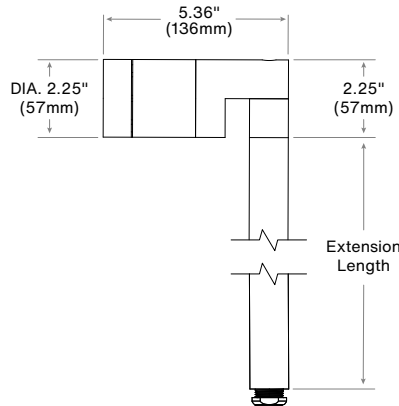
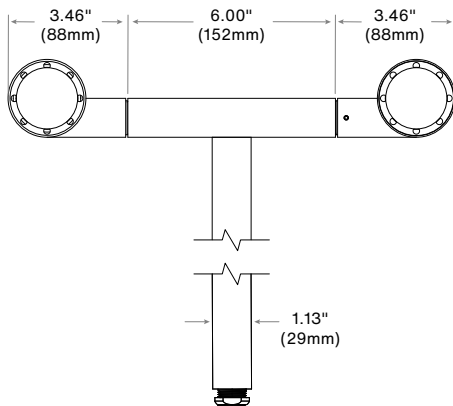

OPTIONS & ACCESSORIES

HOOD OPTIONS

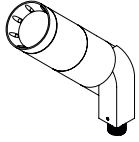

A-HOOD
Versatile hood with 8 weep holes for water drainage. Regressed lens for glare control. Suggested for general use or when fixture is aimed in an up position.

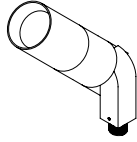

B-HOOD
Similar to A hood but without weep holes. Regressed lens for glare control. Used in an interior or down light application.

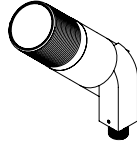

C-HOOD
Flush hood with machined threading on the outside for attachment of C-style glare shield, cleverly designed with hidden drainage channels.

OPTIONAL GLARE SHIELD

For use with A & B Hood, fastened with Set Screw

For use with C Hood fastened with Locking Ring

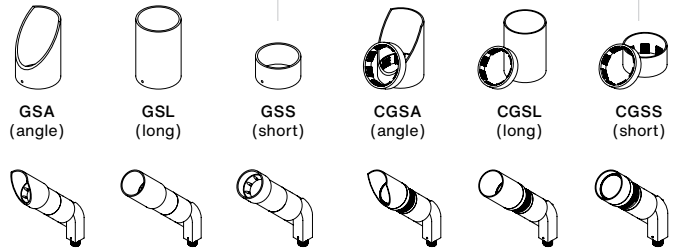

MOUNTING ACCESSORIES

Go to [Accessories](#) for additional options and full specifications.

Canopy Mount:



Fixture On CM5

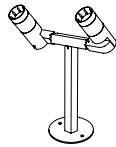

Fixture On CM5



CM1

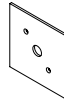

CM3



CM5



CM5-2



CM2

Surface Mount Box:

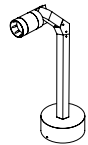

Fixture On CB5.5

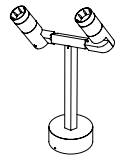

Fixture On CB5.5



CMLJ



CB4.0

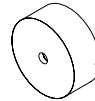

CB5.5

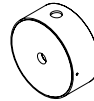

CB5.5-K/O



CB5.1

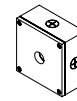

CB4.0-SQ



CB3.5

Ground Mount:

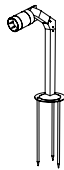

Fixture On MH02-12

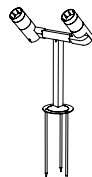

Fixture On MH02-12



JB-1



MH02-06

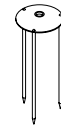

MH02-12



MH05

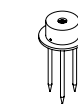

MH02-T-06



MH02-T-12



MHVL6-12



MHVL12-24

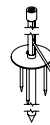

MH01

Ready-made eligible configurations ship in 2 to 4 weeks.

Notes: