

ZSLFM-I

(includes former ZXLi-SL-FM model)

STEP & IN GROUND | ZSLFM Series | 4.25" X 1.50"
4W (135lm) | 120V - 277V | HK LED, Amber



Line voltage Flush Mount Step Light: ZSLFM-IL141-ABR



ZSLFM-IL141-ABR installed profile

FEATURES

- Versatile line voltage, 120V- 277V LED, flush mount step light for use in a range of hardscape and architectural outdoor lighting applications.
- 4W integrated HK LED delivers 135 lumens. 2700 - 4000K CCT, including specialty Amber option.
- Wet Location Listed, IP65 Standard.
- Machined from solid aircraft grade (6061-T6), corrosion-resistant aluminum, then anodized and powder coated to create a highly durable, marine grade finish. Also available in solid brass or stainless steel.
- True flush mount capable with included recessed junction box and adjustable depth flange.
- Every fixture tested end of line for water tightness and light quality.
- Readymade eligible configurations ship in 2 to 4 weeks, complete with selected accessories installed.

SPECIFICATIONS

Materials

Machined from billet 6061-T6 corrosion resistant aluminum with 304 stainless steel hardware. Available in 304/316 stainless steel or 360 brass upon request.

Finish

Aluminum materials are first anodized and then powder coated for a robust, marine grade finish. Stainless steel and brass models are provided with brushed surface.

Voltage

120V - 277V AC.

Wattage

4W HK LED delivers 135 lumens.

Light Engine

Innovative HK LED light engine. CRI 90 Standard. Available in CRI 80 or CRI 95 upon request. Standard CCT options are 2700K, 3000K, 3500K, 4000K. Amber option available. Consult factory for specialty LED specification details.

Dimming

Non dimmable.

Optics

Includes Solite Soft Focus lens for smooth, even distribution of light.

Mounting

Mounts directly in wall or architectural material. Includes recessed housing, junction box, for mounting and wiring. Adjustable flange ensures flush installation into stucco, stone, wood, and other materials.

Listings

ETL Listed for Wet Location, IP67 Standard. RoHS Compliant.

ORDERING GUIDE

EXAMPLE: **ZSLFM-IL141-ABL-120V04W-27**

MODEL	PHYSICAL OPTIONS				MATERIAL / FINISH	POWER		LIGHT	
ZSLFM	IL1	4	1						
ZSLFM Series 4.25" Flush Mount Step Light Integrated HK LED	TYPE	LENGTH	HEIGHT		ABL Aluminum Black	VOLTAGE	WATTAGE PER LIGHT	CCT	
	IL1 Line Voltage, Linear Single Light Integrated Driver	4 4.25"	1 1.5"		ABR Aluminum Bronze	120V 120V (Phase Control)	04W 4 Watts (135lm)	27 2700K	
					AWH Aluminum White	UNIV 120V-277V (0V-10V)	SPW Specialty ²	30 3000K	
					AAC Aluminum Anodized Clear ¹			35 3500K	
					NBR Natural Brass ¹			40 4000K	
					NCU Natural Copper ¹			AM Amber ²	
					NSS Natural Stainless Steel ¹			CC Custom LED	
					CCC Custom Finish ¹				

Ready-made eligible configurations ship in 2 to 4 weeks.

¹ Consult factory for specialty finish quoting and lead times.

² For Specialty AM (Amber LED) and RG (RGB LED), Select SPW (Specialty) for Wattage. Consult factory for LED technical details before Specification or Order.

PRODUCT DRAWINGS

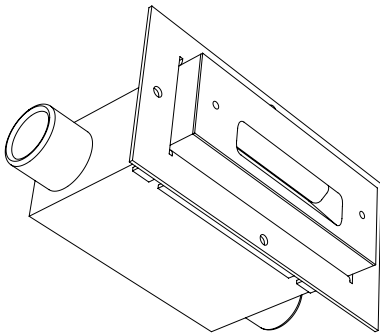

ZSLFM-I
Line Voltage, 120V - 277V

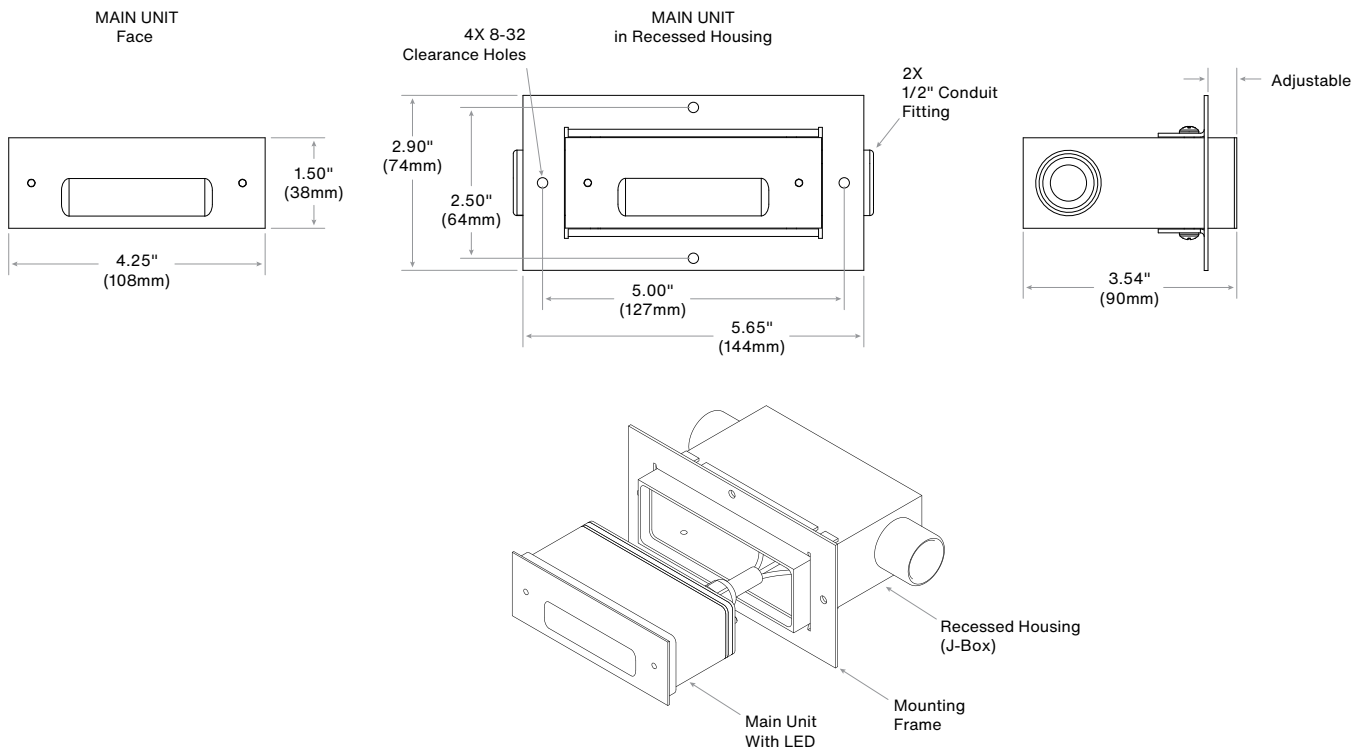

PHOTOMETRY & ENERGY DATA

ZSLFM-I

Input Power	4.3W
Color Temperature (CCT)	3000K
Color Rendering Index (Ra)	84
Max. Candela Angle	0°H, -50°V
Max. Candlepower	101cd
Delivered Lumens	135lm
Efficacy	31lm/W

Polar Graph - Intensity

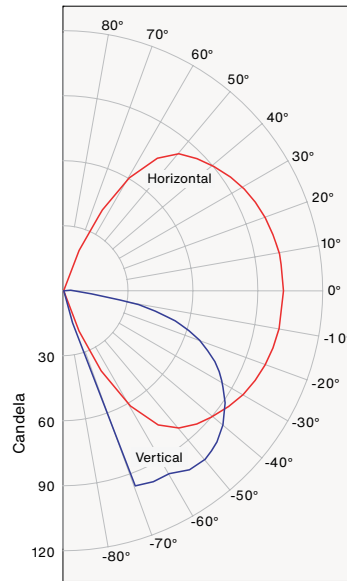

Isocandela Lines of Horizontal Illuminance

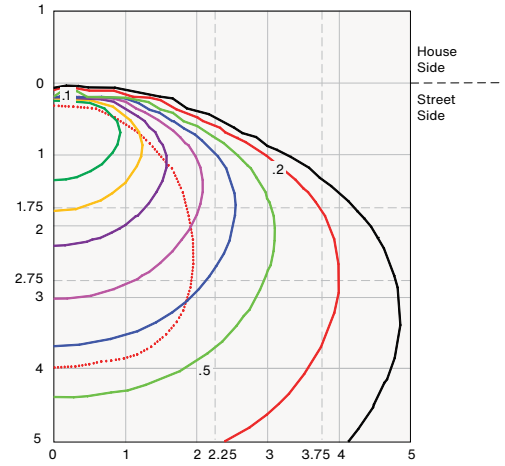

Distance in Units of Mounting Height
Values Based on 1 Foot Mounting Height
1/2 Maximum Candela Trace Shown as Dashed Curve
(+) = Maximum Candela Point

CCT MULTIPLIER

Color Temp.	Multiplier
2700k	0.97
3000k	1.00
4000k	1.05

Notes: