

# ZGLA1 Anchor 1"



IP67

STEP & IN GROUND | ZGA1 Series | 1.00" dia.  
1.7W ( 150lm ) | 12V | HK LED

## FEATURES

- Ultra-compact 1" low voltage (12V) LED fixture for use as a Step, Marker, or In Ground light in architectural outdoor and landscape applications.
- 1.7W integrated HK LED delivering 150 lumens. 2700 - 4000K CCT.
- Available in Standard Direct View, Glare Shield, Top Cover 360°, Top Cover 180°, and Path/Wall Wash configurations, field-changeable after installation.
- Installs vertically or horizontally into masonry, stone, wood, pavers, decking—anywhere a 1" hole can be drilled or PVC sleeve cast.
- Wet Location Listed, IP67 Standard.
- Precision-machined from corrosion-resistant brass. Finishes include Black, Bronze, and Natural Patina.
- 360° rotation adjustment after installation.
- PVC Outer Sleeve simplifies installation in soil or poured concrete.
- Every fixture tested end of line for water tightness and light quality.
- Readymade eligible configurations ship in 2 to 4 weeks, complete with selected accessories installed.

## SPECIFICATIONS

### Materials

Machined from billet 360 brass with 316 stainless steel hardware and silicone placement gaskets.

### Finish

Superior corrosion resistant Natural Brass, Black or Bronze powdercoat for a robust marine grade finish.

### Optional Shields

Glare, Top Cover 360°, Top Cover 180°, and Path/Wall Wash Shields available.

### Voltage

12V AC/DC. Requires remote step down transformer.

### Wattage

1.7W HK LED delivers 150 lumens.

### Dimming

MLV or ELV Phase Control dimming.

### Light Engine

Innovative HK LED Light engine. CRI 90 Standard. Standard CCT options are 2700K, 3000K, 3500K, 4000K.

### Optics

Very Narrow (15°), Narrow (24°), Medium (36°), and Wide (50°) beam spread options available for Standard and Glare Shield Styles. Accepts a single optical accessory. Top Cover and Path/Wall Wash Styles include Shield Optimized optic.

### Mounting

Mounts directly in ground, poured concrete, or any material where a 1" hole can be drilled, including any standard (schedule 40) 1" PVC pipe. Optional PVC Outer Sleeve is available to aid installation (See page 5 for details).

### Listings

ETL Listed for Wet Location, IP67 Standard. Standard Direct View and Top Cover 180° Shields are drive-over rated. RoHS Compliant.



Standard Low Voltage Brass In Ground LED Light:  
ZGLA1-0R1SDV-BBL



ZGLA1-0R1360-BBR with Outer Sleeve



ZGLA1-0R1GLR-BBR installed profile with  
Glare Shield

## ORDERING GUIDE

EXAMPLE: ZGLA1-0R1GLR-NBP-012V02W-30M-LVR-OS

MODEL	PHYSICAL OPTIONS		MATERIAL / FINISH		POWER		LIGHT							
<div>ZGLA1</div> <div>ZGA1 Series 1" In Ground, Step &amp; Marker Light Integrated HK LED</div>	OR1				012V		02W							
	TYPE		STYLE		VOLTAGE		WATTAGE PER LIGHT		CCT					
	OR1	Low Voltage, Round Single Light	SDV	Standard Direct View <sup>1</sup>	NBP	Natural Brass, Patina	012V	12V AC	02W	1.7 Watts (150lm)	27	2700K	N	Narrow (20°) <sup>1</sup>
			GLR	Glare Shield <sup>1</sup>	BBL	Black Powder Coated Brass					30	3000K	M	Medium (35°) <sup>1</sup>
			360	Top Cover 360° <sup>2</sup>							35	3500K	W	Wide (60°) <sup>1</sup>
			180	Top Cover 180° <sup>2,3</sup>	BBR	Bronze Powder Coated Brass					40	4000K		
			PWW	Path/Wall Wash <sup>2,3</sup>	CCC	Custom Finish <sup>4</sup>							S	Shield Optimized, use for 360, 180, PWW Styles <sup>2</sup>

  Readymade eligible configurations ship in 2 to 4 weeks

<sup>1</sup> SDV (Standard Direct View) and GLR (Glare Shield) Styles compatible with user-preferred Optics. Choose V (Very Narrow), N (Narrow), M (Medium), or W (Wide) Light Optic.

<sup>2</sup> 360 (Top Cover 360°), 180 (Top Cover 180°) and PWW (Path Wall Wash) Styles compatible with S (Shield Optimized) Optic only. Choose S (Shield Optimized) Optic.

<sup>3</sup> Style options shipping early 2026

<sup>4</sup> Consult factory for specialty finish quoting and lead times.

<sup>5</sup> Product only accepts one optical accessory

## OPTIONAL INSTALLED ACCESSORIES

### OPTIC ACCESSORIES

<b>LVR</b>	Hexcel Louver <sup>5</sup>
<b>LSL</b>	Linear Spread Lens <sup>5</sup>
<b>SOL</b>	Solite Lens <sup>5</sup>

### INSTALLATION ACCESSORIES

<b>OS</b>	Outer Sleeve, PVC
-----------	-------------------

## ADDITIONAL ACCESSORIES

### SHIELD ACCESSORIES (Includes Optimized Optic)

OPTIONAL	
<b>SDV-A1</b>	Standard Direct View
<b>GLR-A1</b>	Glare Shield
<b>360-A1</b>	Top Cover 360° <sup>6</sup>
<b>180-A1</b>	Top Cover 180° <sup>2,3</sup>
<b>PWW-A1</b>	Path/Wall Wash <sup>2,3</sup>

### OPTIC ACCESSORIES

NOT INSTALLED AT TIME OF ORDER	
<b>LVR-A1</b>	Hexcel Louver
<b>LSL-A1</b>	Linear Spread Lens
<b>SOL-A1</b>	Solite Lens
<b>OPK-A1</b>	Optic Kit for ZGA1 Narrow, Medium, Wide

### INSTALLATION ACCESSORIES

OPTIONAL	
<b>OS-A1</b>	Outer Sleeve

<sup>6</sup> Shield optimized optic included.

## OUTDOOR MAGNETIC TRANSFORMERS (120V input/12VAC Output)

**TRANSFORMERS** (Go to [Accessories](#) for detailed specification)

EXAMPLE: **TXS-150-SS**

MODEL		WATTAGE (VA)						PRIMARY VOLTAGE (VAC)	
<b>TXM</b>	Stainless steel, wet location outdoor magnetic transformer Multitap   12-15VAC Output   MLV Dimming	<b>150</b>	<b>300</b>					<b>OTR-SS (120V Only)</b>	
<b>TXS</b>	Stainless steel, wet location outdoor magnetic transformer Multitap   12VAC Output   MLV Dimming	<b>150</b>	<b>300</b>	<b>600</b>				<b>SS (120V Only)</b>	
<b>TXM</b>	Compact, damp location magnetic transformer 12VAC Output   MLV Dimming	<b>20</b>	<b>40</b>	<b>60</b>	<b>100</b>			<b>120</b>	
<b>IGT</b>	In ground outdoor magnetic transformer 12VAC Output   MLV Dimming	<b>50 (120V Only)</b>			<b>100</b>	<b>300</b>	<b>600</b>	<b>120</b>	<b>277</b>
<b>TXE</b>	In-fixture or near mounted electronic transformer 12VAC Output   ELV Dimming   Enclosure by others	<b>60</b>						<b>120</b>	<b>277</b>

## PRODUCT DRAWINGS

### STANDARD DIRECT VIEW

ZGLA1-0R1SDV

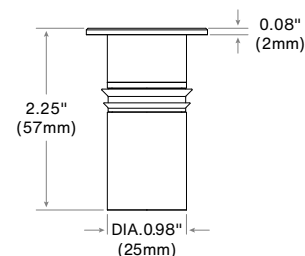
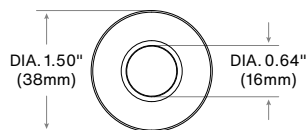
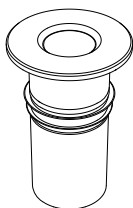

### GLARE SHIELD

ZGLA1-0R1GLR

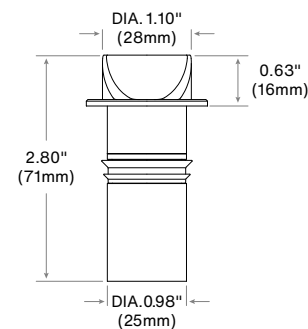
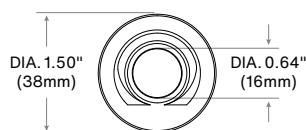
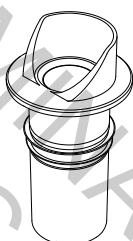

### TOP COVER 360°

ZGLA1-0R1360

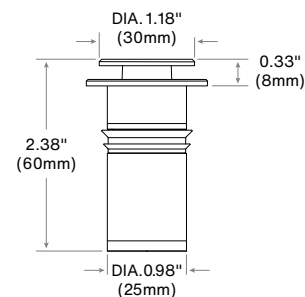
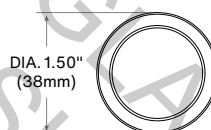
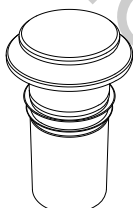

### TOP COVER 180°

ZGLA1-0R1180

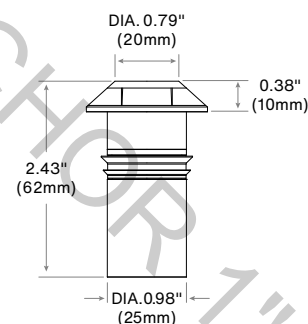
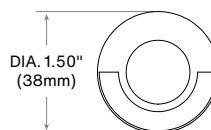
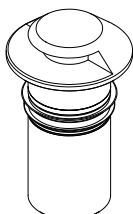

### PATH/WALL WASH

ZGLA1-0R1PWW

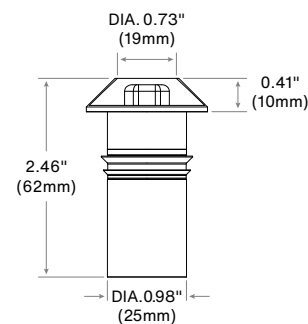
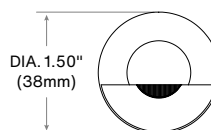
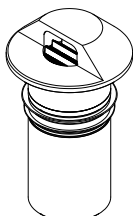

## PRODUCT DRAWINGS



**ZGLA1-OR1SDV**  
with Outer Sleeve

OS-A1

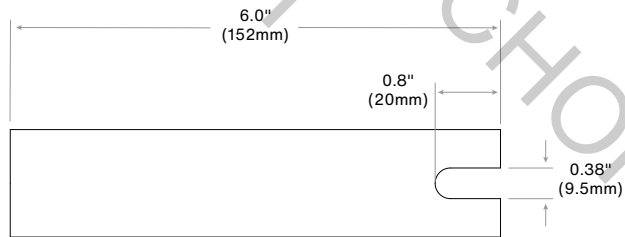
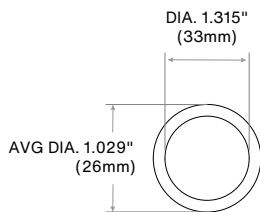
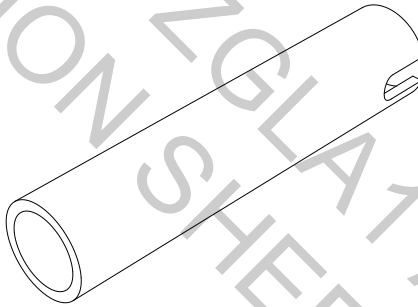

Cut From 1", Schedule 40, PVC Pipe

### Notes:

## OPTIONS & ACCESSORIES

### SHIELD ACCESSORIES

Standard  
Direct View:

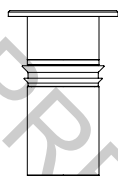

Fixture With SDV



SDV-A1

Glare  
Shield:

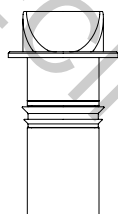

Fixture With GLR



GLR-A1

Top Cover  
180°:

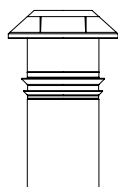

Fixture With 180



180-A1<sup>7</sup>

Top Cover  
360°:

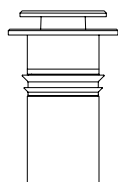

Fixture With 360



360-A1<sup>7</sup>

Path/  
Wall Wash:

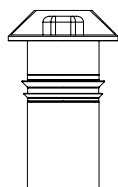

Fixture With PWW



PWW-A1<sup>7</sup>

### INSTALLATION ACCESSORIES

Outer  
Sleeve:

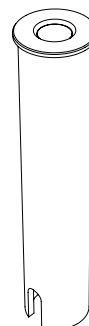

Fixture With OS



OS-A1

 Readymade eligible configurations ship in 2 to 4 weeks.

<sup>7</sup>Top Cover and Path/Wall Wash Shields ship with included Shield Optimized optic.