

ZD20

(includes former ZX20-CM & ZX20-CM-SOi models)

DOWNLIGHT | ZD20 Series | 2.75" dia.
11W (960lm) | 120V, 230V | SORAA, Halogen



SORAA PAR20 Line Voltage Downlight: ZD20-1R1SB-ABL

FEATURES

- 2.75" round, PAR20 lamp-based, line-voltage downlight for architectural outdoor applications.
- Flexible lamp configurations include SORAA® LED lamps with integrated heat sink or compatible PAR20 LED and halogen lamps.
- Wet Location Listed, IP65 Standard.
- Machined from solid billet aircraft-grade (6061-T6), corrosion-resistant aluminum, then anodized and powder coated to create a highly durable, marine-grade finish. Also available in solid brass or stainless steel.
- Accepts up to three optical accessories, including hexcel louvers, spread lenses, and color filters.
- Available with adjustable angled, long, and short glare shields, canopy and surface mounting options.
- Every fixture tested end of line for water tightness and light quality.

SPECIFICATIONS

Materials Machined from solid billet 6061-T6 corrosion-resistant aluminum with 304 stainless steel hardware. Available in 316 stainless steel or 360 brass upon request.	Voltage 120V or 230V AC.	Optics Provided SORAA Lamp delivers 10° beam spread. Select optional SORAA Snap System Beam Spreader magnetic lenses to expand optical beam up to 60°. Accepts up to 3 accessory pieces (hexcel louver, optical lenses, etc.). Secured in place with metal snap ring. (See <i>Ordering Guide for available SORAA lamp options</i>).
Finish Aluminum materials are first anodized and then powder coated for a robust, marine-grade finish. Stainless steel and brass models are provided with brushed surface.	Wattage Max. 11W for SORAA PAR20 lamp.	Mounting Includes CM5 5" Canopy Plate and (2X) 8-32 UNC machine screws to attach to a standard 30 or 3R recessed back box (provided by others).
Hood and Glare Shield Non-weeping Hood Styles. Set screw mounted Angled, Short, or Long Glare Shields. (See <i>page 4 for details</i>)	Light Engine PAR20 Halogen lamp or PAR20 SORAA LED lamp. (See <i>Ordering Guide for available lamp options and specifications</i>)	Listings ETL Listed for Wet Location, IP65 Standard. RoHS Compliant.
Lamp Base/Socket Standard PAR20 E26.	Dimming Phase dimming, with trailing edge dimming preferable. Please refer to website for SORAA PAR20 dimmer compatibility.	

ORDERING GUIDE

EXAMPLE: ZD20-1R1SB-ABL-120V-NL-GSA-LVR-CM5-ABL

MODEL	PHYSICAL OPTIONS			MATERIAL / FINISH			POWER		
ZD20	1R1	S							
ZD20 Series 2.75" Downlight SORRA LED, LED Lamp, or Halogen Lamp Line Voltage (PAR20)	TYPE	STYLE	HOOD	ABL	Aluminum Black		VOLTAGE		LAMP
	1R1 Line Voltage, Round Light	S Standard	B B Style: No Weep Holes	ABR	Aluminum Bronze		120V 120V AC (PAR20 lamp)	NL	No Lamp ²
			C C Style: Threaded, Weeping	AWH	Aluminum White		230V 230V AC (PAR20 lamp)	SL	SORAA Lamp Included ³
				AAC	Aluminum Anodized Clear ¹			SL	SORRA Lamp Not Included ³
				NBR	Natural Brass ¹			CC	Custom Lamp Included
				NCU	Natural Copper ¹				
				NSS	Natural Stainless Steel ¹				
				CCC	Custom Finish ¹				

¹ Consult factory for specialty finish quoting and lead times

² Compatible with Halogen Lamp

³ Only compatible with SORAA LED Lamp

⁴ Mounts to 3R & 3O style junction boxes

OPTIONAL INSTALLED ACCESSORIES

SORAA LAMP	GLARE SHIELD	OPTIC	MOUNTING (Most common listed, see Page 4 for additional options)
XXXXX SORAA LED Lamp Code	GSA B Glare Shield Angled	LVR Hexcel Louver	CANOPY MOUNT
	GSL B Glare Shield Long	OSL Overall Spread Lens	CM5-XXX 5" Round Canopy Plate (Included) ⁴
	GSS B Glare Shield Short	LSL Linear Spread Lens	SURFACE MOUNT
	CGSA C Glare Shield Angled	SOL Solite Soft Focus	CB5.5-XXX 5.5" Round Surface Box
	CGSL C Glare Shield Long	DCF Dichroic Filter	
	CGSS C Glare Shield Short		

• Consult Accessory Spec Sheet for desired option code.

• XXX represents color option.

ADDITIONAL ACCESSORIES (Not installed at time of order)

GLARE SHIELD ACCESSORIES

GSL-16-XXX	B Glare Shield Long
GSA-16-XXX	B Glare Shield Angled
GSS-16-XXX	B Glare Shield Short
CGSL-16-XXX	C Glare Shield Long
CGSA-16-XXX	C Glare Shield Angled
CGSS-16-XXX	C Glare Shield Short

OPTIC ACCESSORIES

LVR-16	Hexcel Louver
OSL-16	Overall Spread Lens
LSL-16	Linear Spread Lens
SOL-16	Solite Soft Focus
DCF-16	Dichroic Filter

PRODUCT DRAWINGS

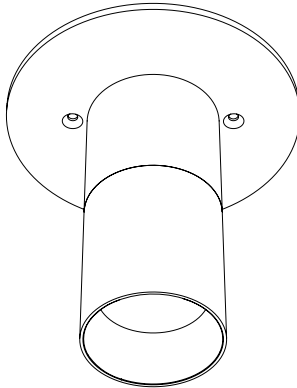

ZD20-1R1SB

ZD20-1R1SB

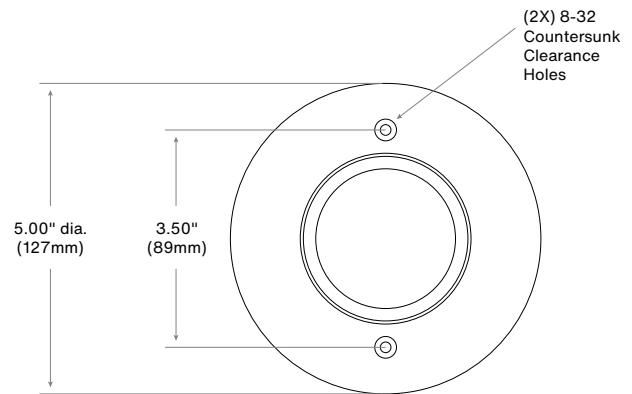
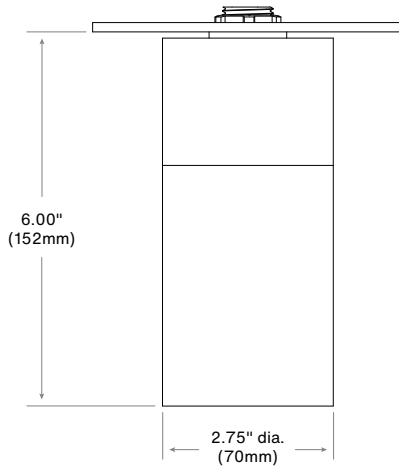

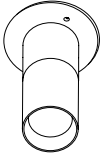
OPTIONS & ACCESSORIES
HOOD OPTIONS

B HOOD

Regressed lens for glare control. Suggested for downlighting and interior applications.

C HOOD

Designed for permanent use with a glare shield and innovative drainage design for water and debris. The machined threads enable ongoing glare shield adjustment, without impact to the paint surface.

OPTIONAL GLARE SHIELD

For use with B Hood, fastened with Set Screw



GSA
(angle)



GSL
(long)



GSS
(short)

For use with C Hood fastened with Locking Ring



CGSA
(angle)



CGSL
(long)

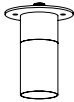

CGSS
(short)

INCLUDED MOUNTING ACCESSORIES
Canopy Mount:

Fixture On CM5

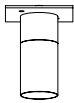

CM5

OPTIONAL MOUNTING ACCESSORIES
Canopy Mount:

Fixture On CM3

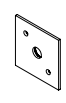

CM1

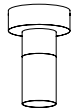

CM3

Surface Mount Box:

Fixture On CB5.5



CB4.0

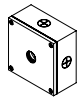

CB4.0-SQ



CB5.1

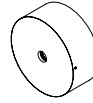

CB5.5

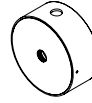

CB5.5-K/O

Notes:
